

APEX

ULTRALITE

LIVE LIFE LIGHTER



7-1/2' WIDE ULTRALITES

STANDARD SOLAR PANELS



200 W. SOLAR PANEL
(ROOF MOUNTED)
30 AMP CONTROLLER

INCLUDED ON EVERY FLOOR PLAN

215 RBK



WEIGHT: 4365

245 BHS



WEIGHT: 4586

8' WIDE ULTRALITES

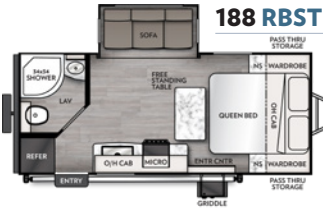

WEIGHT: 4365



WEIGHT: 5586

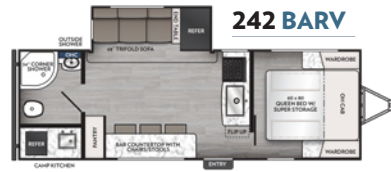

WEIGHT: 4891

243 FKS



WEIGHT: 5906

251 RBK



WEIGHT: 4984

256 BHS



WEIGHT: 5472



WEIGHT: 5982

265 RBSS



WEIGHT: 5652

266 BHS



WEIGHT: 6080

284 BHSS



WEIGHT: 6017

291 TBSS



WEIGHT: 6090

293 RLDS



WEIGHT: 6440

300 BHS



WEIGHT: 5975



423 N. Main Street • P.O. Box 30 • Middlebury, IN 46540
To learn more about Coachmen RV and our products and see how Coachmen is making the easy life easier, visit coachmenrv.com/travel-trailers/apex-ultra-lite



Each Forest River RV is weighed at the manufacturing facility prior to shipping. A label identifying the unloaded vehicle weight of the actual unit and the cargo carrying capacity is applied to every Forest River RV prior to leaving our facilities. The load capacity of your unit is designated by weight, not by volume, so you cannot necessarily use all available space when loading your unit. All information contained in this brochure is believed to be accurate at the time of publication. However, during the model year, it may be necessary to make revisions and Forest River, Inc. reserves the right to make all such changes without notice, including price, color, materials, equipment and specifications as well as the addition of new models and the discontinuance of models shown in this brochure. Therefore, please consult with your Forest River dealer and confirm the existence of any materials, design or specifications that are material to your purchase decision. ©2021 Apex by Coachmen RV, a Division of Forest River, Inc., a Berkshire Hathaway company. All rights reserved. CMR 2469 8/24