

REMOTE

Coachmen

GOING REMOTE NEVER FELT SO GOOD

New with Bunks!

18.2R

Key Floor Plan Features

- ✓ 7' Narrow Body
- ✓ UVW 3,158lbs.
- ✓ **North to South Bunks!**
- ✓ Frameless Oval Windows
- ✓ 16" All-Terrain Tires
- ✓ 200W Solar Panel; 30amp Charge Controller
- ✓ Bike Rack
- ✓ 12V Heat pads for Tanks
- ✓ **Wireless, Removable Bluetooth Speaker**
- ✓ Includes Griddle & Prep Bar

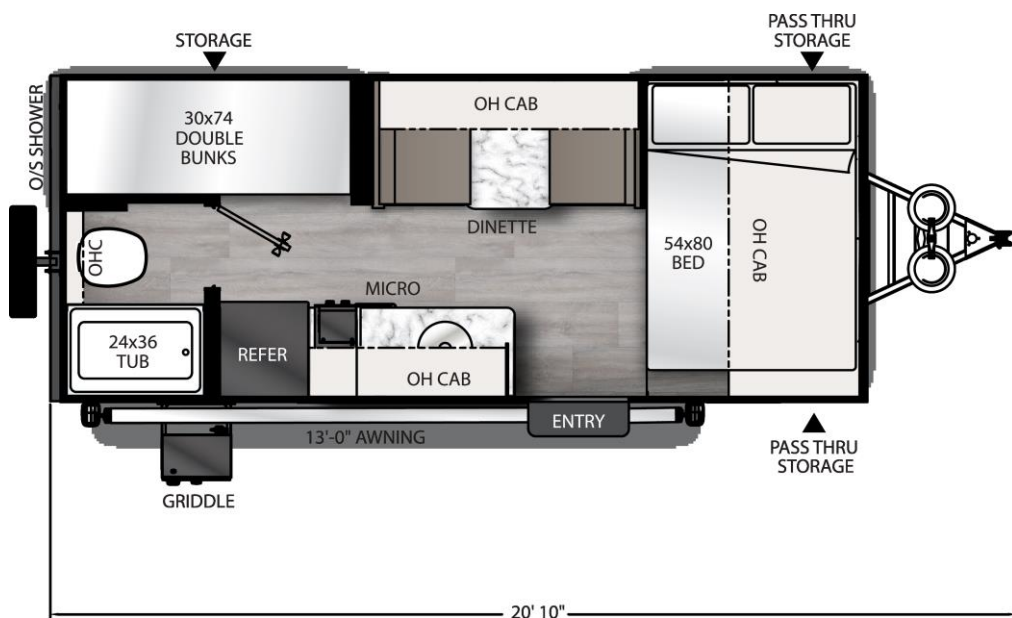

Super Solar Option

- ✓ 1-2000W Inverter
- ✓ 2-100Ah 12V LiFePO4 Battery
- ✓ 2-200W Solar Panels
- ✓ 1-30A MPPT Solar Charge Controller
- ✓ On Demand Instant Hot Water Heater



Step Light!

COACHMEN

****AVAILABLE NOW****